

CR-400PI

红外移动探测器，防 25 公斤宠物

产品性能

CR-400PI 探测器采用经特殊设计的光学传感器，带有独特的四元红外，及最新的 ASIC 芯片，能够极大的减少由小动物或宠物引起的误报。

CR-400PI 根据可视光强度提供多种防宠物等级。该探测器能够在各种安装情形下，提供最优化的探测准确性及稳定性。

CR-400PI 出厂时配置为广角镜片。

- Quad 线性成像技术能够减少探测器自身尺寸，并能区分出背景及小动物成像。
- 基于 ASIC 芯片设计。
- 可防 25 公斤的宠物。
- 采用广角镜片时，探测距离可达 18 米。
- 带温度补偿。
- 简洁设计，适合于家庭中安装。
- 多种脉冲计数可调。
- 灵敏度可调。
- 抗环境干扰。
- 安装高度自由(1.8m – 2.4m)。
- LED 远程功能。

安装位置选择

要选择一个较容易探测到入侵者的安装位置（我们建议装在某个角落）。参见探测范围图图.3。四元红外传感器探测横穿过探测光束的移动非常灵敏，相对而言，探测朝向探测器方向的移动灵敏度就要低一点。当周围环境较稳定无杂音信号干扰时，CR-400PI 探测器能够表现出最好的性能。

避免以下的安装位置

- 直接面对太阳光，被直射。
- 朝向可能产生温度快速变化的区域。
- 空气尘大，气流大的区域。

线缆型号要求

使用 #22 AWG (0.5 mm) 或者更大直径的线缆。根据下表选择适当的线缆直径。

线缆长度	m	200	300	400	800
线缆直径		.5	.75	1.0	1.5
线缆长度	ft.	800	1200	2000	3400
线缆直径	#	22	20	18	16

探测器安装

该探测器 可以选择墙装或角落装。

如果需要吸顶安装或一些特殊墙面安装，建议使用可选配件中的专用支架。参见支架描述（见图. 6）。

1. 要打开探测器外壳，先取下螺丝，轻轻的揭开塑料外壳。



图.1 固定螺丝

2. 取下 PCB 主板上的固定螺丝，卸下 PCB 主板。
3. 根据走线方式，打通背面的走线孔。

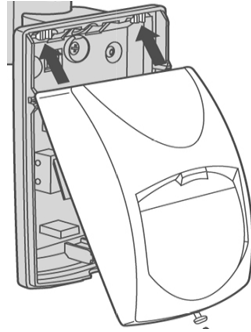
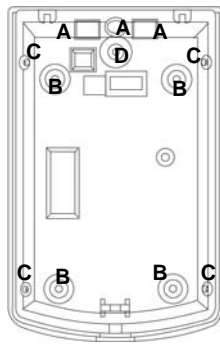

- A. 线孔
- B. 用于在平面墙壁安装
- C. 角落安装时，使用这四个孔位。对过于狭窄的角落，可以只安装 2 个孔（一侧的）
- D. 用于支架安装

图.2

4. 底部一些圆形及方形的缺口是用做线孔的。用户也可以使用未作固定用的定位孔来走线。（选用支架时，线缆成支架中穿过）。
5. 将探测器固定于墙壁，角度或天花板（支架安装详见图 6）。
6. 重新上好 PCB 主板，固定好螺丝，将线缆接入接线端子。
7. 将外壳盖好

探测器接线图

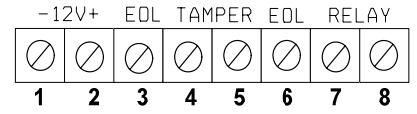

端子 1 - 标有 “-” (GND)

接入电压负极或主机共地端。

端子 2 - 标有 “+” (+12V)

电源正极输入，电压范围 8.2 -16V 直流。（通常由报警主机供电）

端子 3 & 6 - 标有 “EOL” – 末端电阻。

端子 4 & 5 - 标有 “TAMPER”

如果要使用防拆功能，接入此对端子到主板 24 小时防区。如果探测器外壳打开的话，立即就会有报警信号传输到报警主机。

端子 7 & 8 - 标有 “RELAY”

此端子为探测器的报警输出端子。将他们接入报警主机的常闭防区。

测试探测器

在供上 12 伏直流电后，等一分钟预热。保证测试区域无人。

步行测试

1. 打开外壳
2. 将 LED 灯打到 ON 位置。
3. 盖好外壳
4. 慢慢横着走过保护区域。
5. 观察移动时，LED 灯是否亮起。
6. 每次移动间，间隔 5 秒，等探测器恢复稳定。
7. 在步行测试结束后，建议将 LED 灯打到 OFF 位置。

注意：

至少一年要做一次步行测试，用于确保元件工作正常，及探测范围正常。



图.3

CR-400PI

红外移动探测器，防 25 公斤宠物

探测器设置

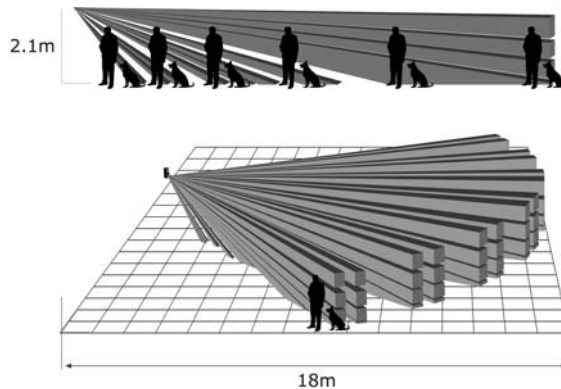
防宠功能设置

本跳线用于设置防宠物功能，可设最大为 15 公斤或 25 公斤，视乎宠物的体形。

PET 25Kg 15Kg 宠物不超过 15 公斤

PET 25Kg 15Kg 宠物不超过 25 公斤

脉冲计数设置

本跳线用于设定脉冲计数，可以根据环境来调节探测灵敏度。

3 2 1 PULSE 非常稳定的环境
跳线 #1 = ON
无宠物

3 2 1 PULSE 中等环境
跳线 #2 = ON
宠物不超过 15 kg

3 2 1 PULSE 高误报几率环境
跳线 #3 = ON
宠物不超过 25 kg

LED 灯设置

本跳线用于设定 LED 开关的状况。

LED ON OFF ON - LED 打开. 当探测器探测到入侵时, LED 会亮起。

LED ON OFF OFF - LED 关闭, LED 灯被关闭, .

注意: LED 灯的设置并不影响探测器的探测性能。
当入侵情况被探测到时, LED 会进入激活, 报警输出继电器也会进入触发状态 2 秒。

PIR 红外灵敏度调节

使用 标有“SENS”的旋钮到调节传感器的灵敏度, 范围是 15%到 100%, 具体数值可根据步行测试结果而定. (出厂设置为 57%)
顺时针旋转旋钮可以增大距离, 逆时针则减少距离。



图.5

可选 支架安装图示

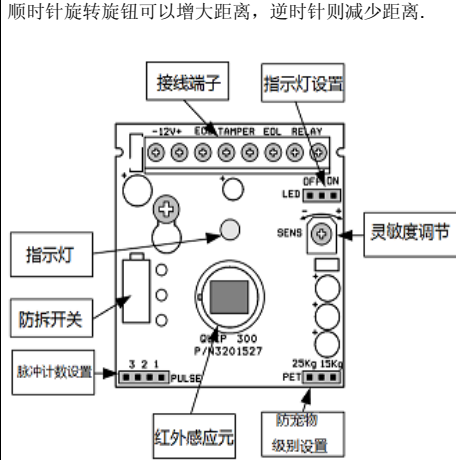

图. 6

技术参数

模式	CR-400PI 四元红外
探测方式	四元红外传感器
工作电压	8.2 到 16 V 直流
电流消耗	待机: 8mA (± 5%) 触发: 10mA (± 5%)
温度补偿	是
脉冲计数	可调
报警时间	2 秒 (± 0.5 秒)
报警输出	常闭 28VDC 0.1 A 带 270hm 线阻
防拆开关	常闭 28VDC 0.1A 带 10 Ohm 线阻, 当外壳打 开时开路
预热时间	60 秒 (± 5 秒)
测试速度	0.3-2.5 m/sec
LED 指示	触发时 LED 灯亮
工作温度	-20°C 到 +60°C
抗可视光干扰.	不高于 10000lux
抗 RFI 干扰	30V/m 10 - 1000MHz
EMI 保护	50,000V
外形尺寸	92mm x 59mm x 37mm
重量	40 克

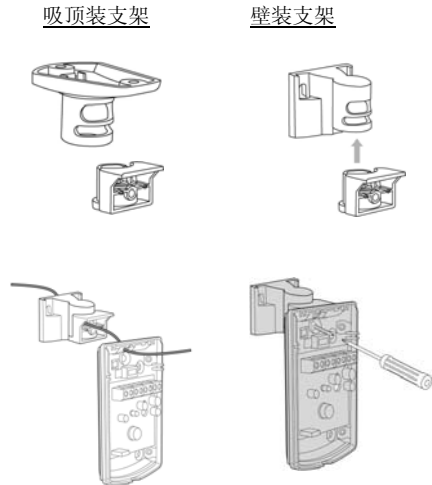

CROW ELECTRONIC ENGINEERING LTD. ("Crow") - WARRANTY POLICY CERTIFICATE

This Warranty Certificate is given in favor of the purchaser (hereunder the "Purchaser") purchasing the products directly from Crow or from its authorized distributor.
Crow warrants these products to be free from defects in materials and workmanship under normal use and service for a period of 24 months from the last day of the week and year whose numbers are printed on the printed circuit board inside these products (hereunder the "Warranty Period").

Subject to the provisions of this Warranty Certificate, during the Warranty Period, Crow undertakes, at its sole discretion and subject to Crow's procedures, as such procedures are from time to time, to repair or replace, free of charge for materials and/or labor, products proved to be defective in materials or workmanship under normal use and service. Repaired products shall be warranted for the remainder of the original Warranty Period.

All transportation costs and in-transit risk of loss or damage related, directly or indirectly, to products returned to Crow for repair or replacement shall be borne solely by the Purchaser.
Crow's warranty under this Warranty Certificate does not cover products that is defective (or shall become defective) due to: (a) alteration of the products (or any part thereof) by anyone other than Crow; (b) accident, abuse, negligence, or improper maintenance; (c) failure caused by a product which Crow did not provide; (d) failure caused by software or hardware which Crow did not provide; (e) use or storage other than in accordance with Crow's specified operating and storage instructions.

There are no warranties, expressed or implied, of merchantability or fitness of the products for a particular purpose or otherwise, which extend beyond the description on the face hereof.

This limited Warranty Certificate is the Purchaser's sole and exclusive remedy against Crow and Crow's sole and exclusive liability toward the Purchaser in connection with the products, including without limitation - for defects or malfunctions of the products. This Warranty Certificate replaces all other warranties and liabilities, whether oral, written, (non-mandatory) statutory, contractual, in tort or otherwise.

In no case shall Crow be liable to anyone for any consequential or incidental damages (inclusive of loss of profit, and whether occasioned by negligence of the Crow or any third party on its behalf) for breach of this or any other warranty, expressed or implied, or upon any other basis of liability whatsoever. Crow does not represent that these products can not be compromised or circumvented: that these products will prevent any person injury or property loss or damage by burglary, robbery, fire or otherwise: or that these products will in all cases provide adequate warning or protection.

Purchaser understands that a properly installed and maintained product may in some cases reduce the risk of burglary, fire, robbery or other events occurring without providing an alarm, but it is not insurance or a guarantee that such will not occur or that there will be no personal injury or property loss or damage as a result.

Consequently, Crow shall have no liability for any personal injury, property damage or any other loss based on claim that these products failed to give any warning.

If Crow is held liable, whether directly or indirectly, for any loss or damage with regards to these products, regardless of cause or origin, Crow's maximum liability shall not in any case exceed the purchase price of these products, which shall be the complete and exclusive remedy against Crow.

CROW ELECTRONIC ENGINEERING LTD.

ISRAEL:	Crow Electronic Engineering Ltd. 12 Kineret St. Airport City P.O. Box 293 Ben Gurion Airport , 70100 Tel: 972-3-9726000 Fax: 972-3-9726001 E-mail: support@crow.co.il
USA:	2160 North Central Road, Fort Lee, N.J. 07024 Tel: 1-800-GET CROW or (201) 944 0005 Fax: (201) 944 1199 E-mail: support@crowelec.com
AUSTRALIA:	429 Nepean HWY Brighton East Vic 3187 Tel: 61-3-9596 7222 Fax: 61-3-9596 0888 E-mail: crow@crowaust.com.au
POLAND:	VIDICON SP. ZO. O. 15 Powazkowska St. 01 - 797 Warsaw Poland Tel: 48 22 562 3000 Fax: 48 22 562 3030 E-mail: vidicon@vidicon.pl
LATIN AMERICA:	CROW LATIN AMERICA 5753 NW 151 st Street MIAMI LAKES FL 33014 - USA Tel: +1-305-823-8700 Tel: +1-305-823-8711 E-mail: sales@crowlatinamerica.com
ITALY:	DEATRONIC VIA Giulianello 4/14 00178 ROMA, ITALY Tel: +39-0676-12912 Fax: +39-0676-12601 E-mail: info@deatronic.com

These instructions supersede all previous issues in circulation prior to June 2005.